



VACUUM TUBE SOCKET

(VT8 SERIES)

High Insulated 8 Pin Vacuum Tube Socket

Features

- With panel saddle mounting
- Easy mount with the saddle of **extruded screw** hole
- Phosphorus bronze terminal pin with solder plating
- Glassfiber filled PPS Insulating material

Applications

- Applicable to all types of electric and electronic equipments using vacuum tube and relay

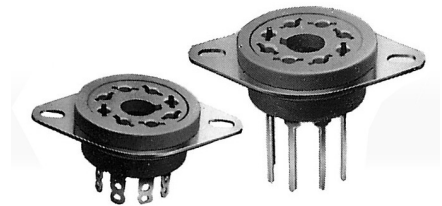

Dimensions

VT8-ST

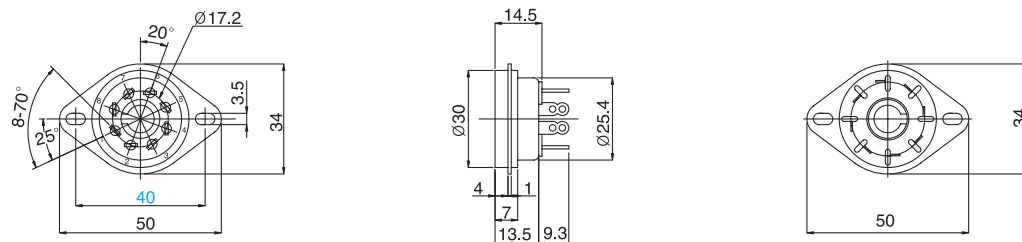

VT8-PT

P.C.B Mounting Hole

