

FURUTECH

PURE TRANSMISSION



CF35(R) Adaptor
6.3 stereo to 3.5 stereo

Features:

- The Furutech CF35(R) --- 6.3 Stereo to 3.5 stereo Adaptor
- Main conductor: RoHS Compliant Rhodium-plated α (Alpha) phosphor bronze and copper alloy
- Insulated: POM resin.
- Housing Material: Rhodium-plated α (Alpha) copper alloy and Carbon fiber finished
- Overall Size: 11.5mm ϕ X 61.0mm (L) approx.

Outside Size and Overall Image

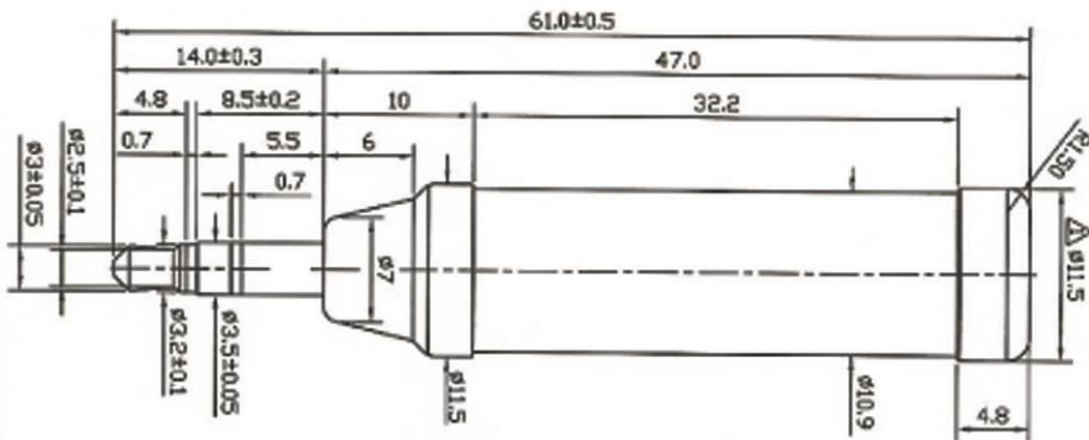

FURUTECH CO., LTD.
service@furutech.com

Make A More Powerful Connection With Furutech!

Product name	Product Introduction	JAN CODE
CF35(R)	High End Performance 6.3 Stereo to 3.5 Stereo Adaptor	